

FULL SHADE PLANTING PALETTE

Full Shade areas receive less than 3 of sun in a day
New planting is 200 square feet

Name: _____

Address: _____

Plant 1 Top Choice: _____

Plant 1 2nd Choice: _____

Stepping Stone Path: _____

PLANTING NOTES

Follow these notes to place your plants in the best location for them to thrive.

Always space all plants 15-inches from the center of one plant to the center of the next one, even if the plant tags say to place them differently.

Plant 5 should mostly be placed beside the street. This is a salt tolerant plant and will do better in the areas that receives more street salt in wintertime.

The remaining plants can be scattered throughout the boulevard in groupings as shown.

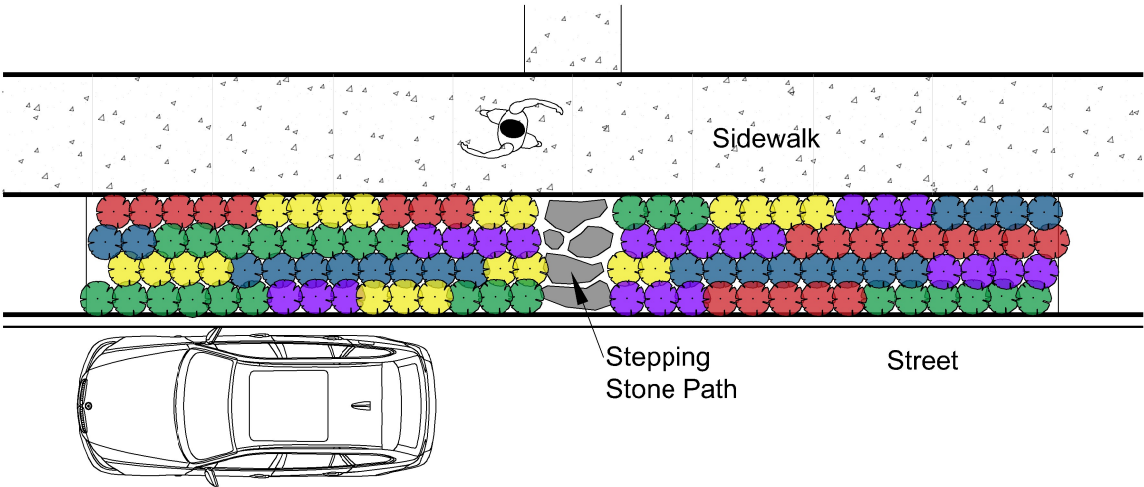

PLANT LIST (Possible Substitutions)

- Plant 1: Bradbury's Monarda or Penstemon or Jacob's Ladder
- Plant 2: Zigzag Goldenrod (Elm-Leaved Goldenrod)
- Plant 3: Wild Geranium (Columbine or Tall Thimbleweed)
- Plant 4: Big Leaved Aster (Heart Leaved Aster or Short's Aster)
- Plant 5: Curly Styled Wood Sedge (Plains Oval Sedge or Long Beaked Sedge)

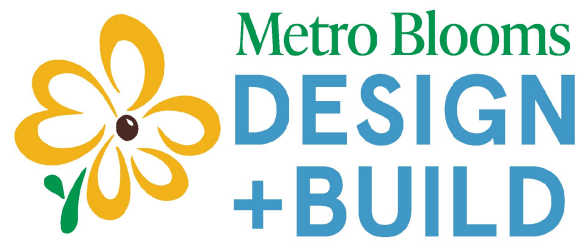

Bradbury's Monarda



Penstemon



Jacob's Ladder

