

# PART SUN/PART SHADE PLANTING PALETTE

Part Sun/Shade areas receive 3 to 6 hours of sun in a day  
New planting is 200 square feet

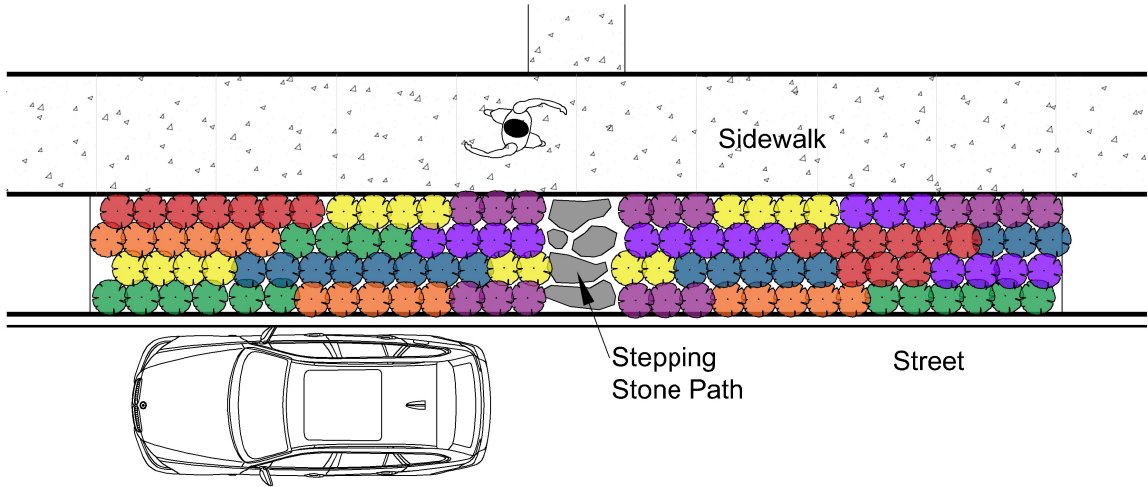

## PLANT LIST (Possible Substitutions)

- Plant 1: Bradbury's Monarda or Penstemon or Jacob's Ladder
- Plant 2: Tall Thimbleweed (Spotted Bee Balm)
- Plant 3: Wild Geranium (Columbine)
- Plant 4: Pussytoes (Nodding Onion)
- Plant 5: Short's Aster (Heart Leaved Aster or Sky Blue Aster)
- Plant 6: Blue Grama (Side Oats Grama)
- Plant 7: Plains Oval Sedge (Long Beaked Sedge)

Name: \_\_\_\_\_

Address: \_\_\_\_\_

Plant 1 Top Choice: \_\_\_\_\_

Plant 1 2nd Choice: \_\_\_\_\_

Stepping Stone Path: \_\_\_\_\_

## PLANTING NOTES

Follow these notes to place your plants in the best location for them to thrive.

Always space all plants 15-inches from the center of one plant to the center of the next one, even if the plant tags say to place them differently.

Plant 4 should be placed beside the stepping stone path or beside the sidewalk. This is a short plant species and will not flop over onto the stepping stones or sidewalk.

Plant 7 should mostly be placed beside the street. This is a salt tolerant plant and will do better in the areas that receives more street salt in wintertime.

The remaining plants can be scattered throughout the boulevard in groupings as shown.



Bradbury's Monarda



Penstemon



Jacob's Ladder

