

Pollinator Garden Template

For Sunny & Dry Sites

These Minnesota native perennial plants prosper in moderately dry soils with more than 4 hours of direct sunlight per day.



Planting Notes & Recommendations

- If your garden is a different shape or size than this template, that's ok! These notes will help you to arrange plants appropriately.
- Plant species in clusters of three or more individuals and repeat these clusters across the garden.
- Consider which directions your garden will be viewed from.
 - » Keep shorter species towards the edge or front of the garden bed where they maintain visibility.
 - » Use taller species as a backdrop.

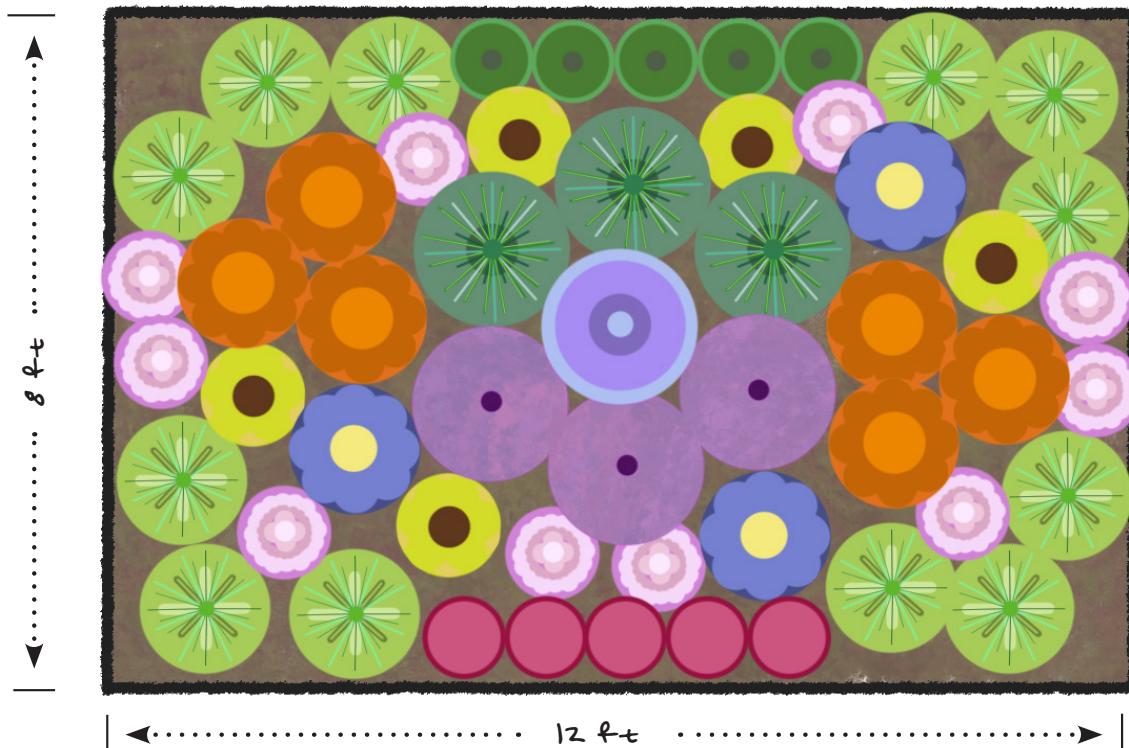

	Nodding onion <i>Allium cernuum</i>	2 ft Height 1 ft Spacing		Meadow blazing star <i>Liatris ligulistylis</i>	5 ft Height 1.5 ft Spacing
	Anise hyssop <i>Agastache foeniculum</i>	4 ft Height 1.5 ft Spacing		Black-eyed Susan <i>Rudbeckia hirta</i>	2 ft Height 1 ft Spacing
	Butterfly milkweed <i>Asclepias tuberosa</i>	2 ft Height 1.5 ft Spacing		Little bluestem <i>Schizachyrium scoparium</i>	3 ft Height 1.5 ft Spacing
	Prairie smoke <i>Geum triflorum</i>	1 ft Height 1 ft Spacing		Prairie dropseed <i>Sporobolus heterolepis</i>	2 ft Height 1.5 ft Spacing
	Alumroot <i>Heuchera richardsonii</i>	2 ft Height 1 ft Spacing		Sky-blue aster <i>Symphyotrichum oolentangiense</i>	3 ft Height 1.5 ft Spacing

Timing of Blooms

The garden template combines species of native wildflowers with staggered bloom times from spring to early fall. This provides pollinators with crucial pollen and nectar sources throughout the entire season.

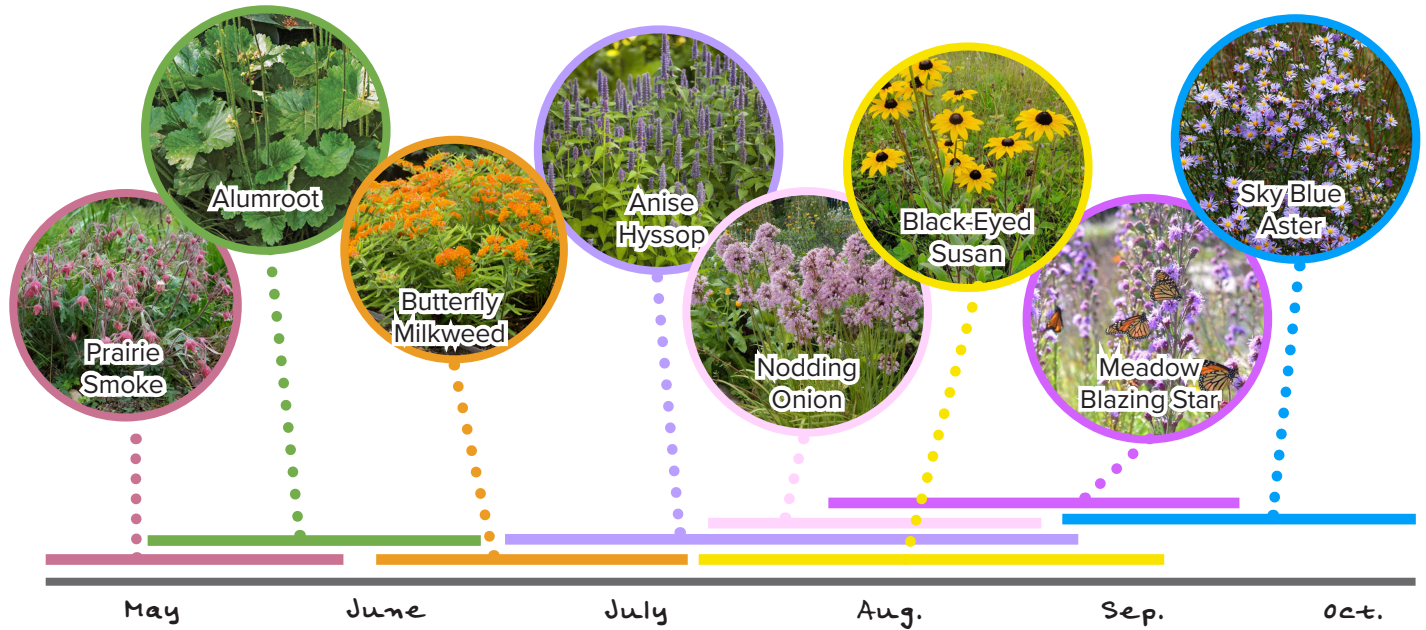

Species Substitutes

0 to 1 Ft in Height

Wild strawberry - *Fragaria virginiana*

Pussytoes - *Antennaria neglecta*

1 to 3 Ft in Height

Prairie onion - *Allium stellatum*

Purple prairie clover - *Dalea purpurea*

Pearly everlasting - *Anaphalis margaritacea*

Aromatic aster - *Symphotrichum oblongifolium*

Side oats grama - *Bouteloua curtipendula*

Lead plant - *Amorpha canescens*

3 to 4 Ft in Height

Rough blazing star - *Liatris aspera*

Rattlesnake master - *Eryngium yuccifolium*

Check out Blue Thumb's Plant Finder tool for more information on these and other native Minnesota native plants!

<https://bluethumb.org/plantfinder/>

In partnership with:

